

Magdalen Cycle Shelter BXMW/MAG



Standard Unit Dimensions

Width: 2010mm

Height: 2100mm (to eaves)

Length with Capacities

2010mm 6 cycles

Features

- Robust modular construction
- Load bearing purlins
- Welded end frames
- Made from heavy-duty mild steel circular and box section
- Assembled with anti-tamper high strength bolts
- Anti-climb end frames
- Adjustable baseplates
- Hot dip galvanized to BS EN ISO 1461:2009
- Weather resistant cladding

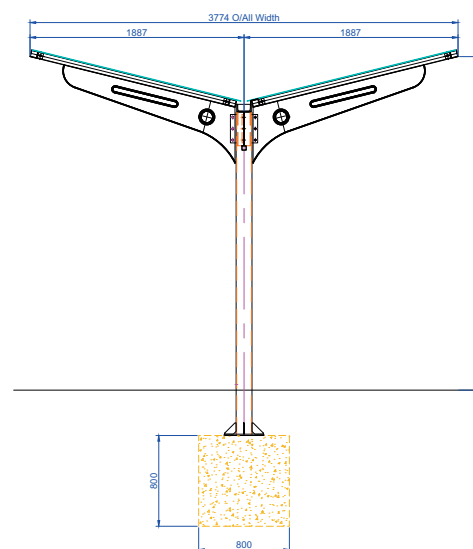
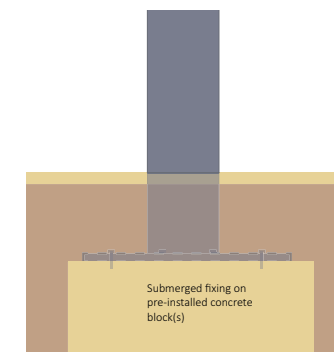
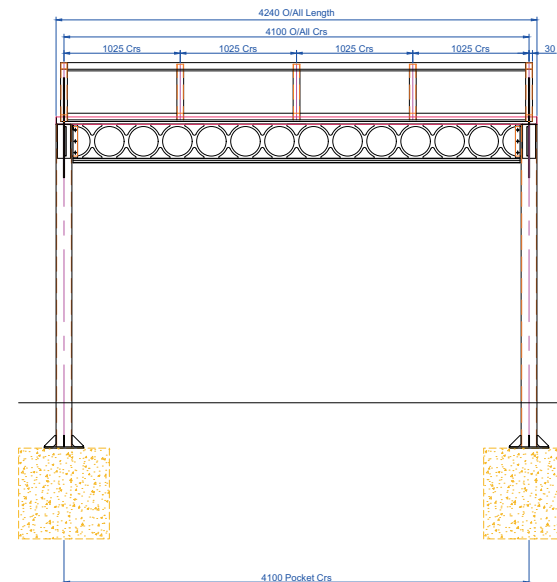

Specification Sheet



Magdalen Cycle Shelter BXMW/MAG

Materials Used

Framework - Mild Steel Circular Uprights and Patent Glazing Bars

Cladding - 9.5mm Heat Soaked, Toughened Laminated Glass

Fasteners - Zinc Plated

Finish Options

Hot-Dip Galvanized to BS EN ISO 1461:2009

Hot-Dip Galvanized & Polyester Powder Coated 60mm-120mm dft

Hot-Dip Galvanized with Duplex (Zinc Coated) Powder Coating (coastal) 180-240 overall dft

Weather Resistance

Cladding is UV Stabilised

Wind resistant to 23m/s

Fire Resistance

Cladding is fire tested to '1Y' for BS 476

Design-Life, Guarantees & Warranties (terms apply)

25 year structural guarantee

34 year (min) life expectancy for Hot Dip Galvanizing

8-10 year life expectancy on standard powder coatings

10-15 year life expectancy on Duplex (Zinc Coated) powder coatings

10 years manufacturers guarantee on cladding material

10 year warranty on product materials

12 year warranty on parts & labour

Installation

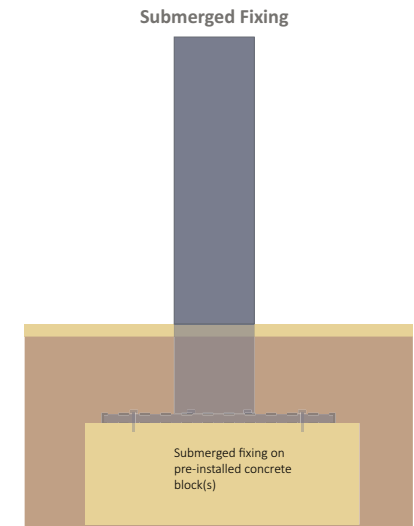

Options

PETg UV Polycarbonate Cladding

Steel Profile, Trapezoidal roof cladding

Opal Cladding to Roof and Side

Powder Coating to a wide range of colours

LED or solar lighting

Full Installation Service

Varied Range of Cycle Racks

Varied Range of Cycle Stands

Colours/Finishes



THE COLOURS SHOWN ARE A GUIDE ONLY.
PLEASE CHECK A COLOUR CHART TO SEE THE
ACTUAL COLOUR.

Please Note: All information on this data sheet is subject to orientation (N,S,E,W) altitude and proximity to buildings, but is sufficient for use as general/preliminary information)