

# Specification Sheet



## Icarus Cycle Shelter BXMW/ICR



### Standard Unit Dimensions

Width: 4885mm

Height: 2999mm

### Length with Capacities

3600mm 16 cycles

4100mm 20 cycles

5000mm 24 cycles

### Features

Robust modular construction

Load bearing purlins

Welded end frames

Made from heavy-duty mild steel box section

Assembled with anti-tamper high strength bolts

Decorative Spandrels

Anti-climb end frames

Adjustable baseplates

Hot dip galvanized to BS EN ISO 1461:2009

Weather resistant cladding

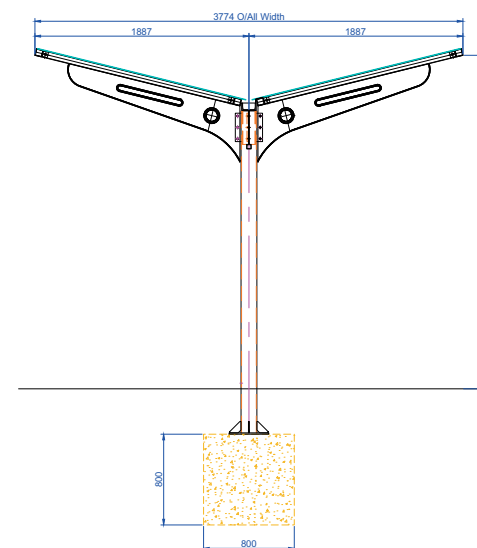
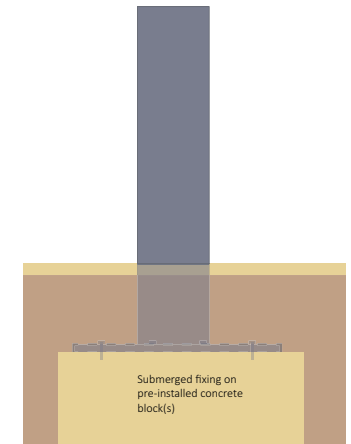
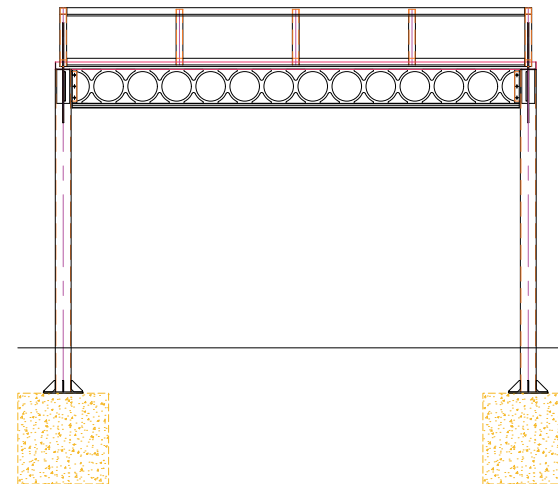

## Icarus Cycle Shelter BXMW/ICR

### Materials Used

Framework - Mild Steel

Cladding - 16mm Structured Multiwall Polycarbonate

Fasteners - Zinc Plated

Cover Strips - Pre-galvanized steel flat

### Finish Options (Framework)

Hot-Dip Galvanized to BS EN ISO 1461:2009

Hot-Dip Galvanized & Polyester Powder Coated 60mm-120mm dft

Hot-Dip Galvanized with Duplex (Zinc Coated) Powder Coating (coastal) 180-240 overall dft

### Weather Resistance

Cladding is UV Stabilised

Wind resistant to 23m/s

### Fire Resistance

Cladding is fire tested to '1Y' for BS 476

### Design-Life, Guarantees & Warranties (terms apply)

25 year structural guarantee

34 year (min) life expectancy for Hot Dip Galvanizing

8-10 year life expectancy on standard powder coatings

10-15 year life expectancy on Duplex (Zinc Coated) powder coatings

10 years manufacturers guarantee on cladding material

10 year warranty on product materials

12 year warranty on parts & labour

### Installation

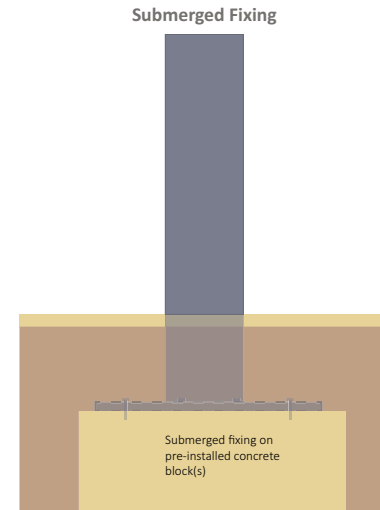

### Options

4 mm PETG uv cladding

Steel Profile, Trapezoidal roof cladding

Opal Cladding to Roof and Sides

Powder Coating to a wide range of colours

LED or solar lighting

Full Installation Service

Varied Range of Cycle Racks

Varied Range of Cycle Stands

### Colours/Finishes



THE COLOURS SHOWN ARE A GUIDE ONLY.  
PLEASE CHECK A COLOUR CHART TO SEE THE  
ACTUAL COLOUR.

*Please Note: All information on this data sheet is subject to orientation (N,S,E,W) altitude and proximity to buildings, but is sufficient for use as general/preliminary information)*