

## Newcastle Duopitch Lattice BXMW/DUO-LATT



### Standard Unit Dimensions:

Bespoke sizes to suit  
customer requirements

### Framework Colours/Finishes:

Galvanised Only	White Aluminium	Anthracite Grey
BS 4800 10 A 07 Nimbus Grey	Traffic Red	Jet Black
BS 4800 14 C 39 Holly Green	Traffic Yellow	Goose Grey
Mid Blue	Dark Blue	Traffic White

The colours shown are a guide only.  
Please check a colour chart to see the  
actual colour.

## Product Information

This Duopitch Lattice Canopy was initially built to provide coverage to a school courtyard for outdoor dining, but can be used in most applications. The Newcastle Duopitch Canopy has a range of uses, these include: Entrance canopies, Covered walkways, and Outdoor classrooms. This canopy also includes the following features; Offset apex roof, Clear multi-wall polycarbonate cladding and Submerged fixing.

## Features

- Offset apex roof
- Clear multi-wall polycarbonate cladding
- Submerged fixing
- Welded end frames and purlin section made from heavy-duty box
- Hot dipped galvanised to BS EN ISO 1461:2009

## Materials Used

- Framework - Mild steel
- Cladding - 16mm structured multi-wall polycarbonate
- Fasteners - Zinc plated
- Cover Strips - Aluminium capex

## Finish Options (Framework)

- Galvanised to BS EN ISO 1461:2009
- Galvanised to BS EN ISO 1461:2009 & Polyester Powder Coated

Broxap Limited, Rowhurst Industrial Estate, Chesterton, Newcastle-under-Lyme, Staffordshire, ST5 6BD T: 01782 564411 E: info@broxap.com W: www.broxap.com

## Newcastle Duopitch Lattice BXMW/DUO-LATT

### Weather Resistance

Cladding is UV Stabilised  
Wind resistant to 23m/s

### Fire Resistance

Cladding is fire tested to '1Y' for BS 476

### Guarantees, Warranties, Design-Life and Life-Expectancies

- 25 year structural guarantee\*
- 34 year (min) life expectancy for Hot Dip Galvanizing
- 8-10 year life expectancy on standard powder coatings
- 10-15 year life expectancy on Duplex (Zinc Coated) powder coatings
- 10 years' manufacturers guarantees\* on cladding material(s)
- 10 years' warranty\* on material (only)
- 12 months' warranty\* on parts & labour

\*Maintenance and other qualifying criteria apply





### Options

- Internal lighting or solar lighting
- Opal, bronze or grey tinted multi-wall polycarbonate
- Full installation service

#### Standard Unit Dimensions:

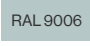
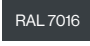
Bespoke sizes to suit  
customer requirements

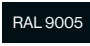
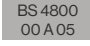
#### Framework Colours/Finishes:

		
Galvanised Only	White Aluminium	Anthracite Grey
		
BS 4800 10 A 07 Nimbus Grey	Traffic Red	Jet Black
		
BS 4800 14 C 39 Holly Green	Traffic Yellow	Goose Grey
		
Mid Blue	Dark Blue	Traffic White

The colours shown are a guide only.  
Please check a colour chart to see the  
actual colour.

### Diagram

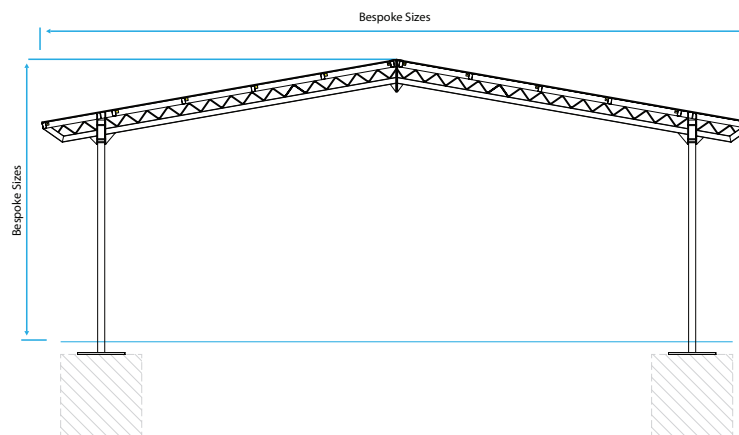

### Installation

