

Photo: John McHugh Design



Bench seating has been installed into Wembley Park, London to create a striking sculptural centre piece.

## BX60 Bench Modular Seating

*Ultra contemporary in design,  
Bench creates the ultimate structure to  
show off any exterior or interior  
features, whilst also providing a  
comfortable seat*

BX60 107 seat (A-I)  
BX60 107 coffee table (J)

# GeoMet

# broxap®

Seating, water features & planters

01782 564411 [www.broxap.com](http://www.broxap.com)





Photos: John McHugh Design



## BX60 Bench Modular Seating

Simple lines & colour add beauty and value to exteriors or interior gyms, sports venues, schools & colleges, meeting areas, waiting rooms, shelters, showrooms, exhibitions, foyers and lobbies.

Ultra contemporary in design, Bench creates the ultimate structure to show off any exterior or interior features, whilst also providing a comfortable seat.

Our modular designs are composite moulded and create striking landscape features. Each seat can be made in any BS/RAL colour to match any colour scheme or corporate interior. Bench is easy to install as it's lightweight and modular in construction.



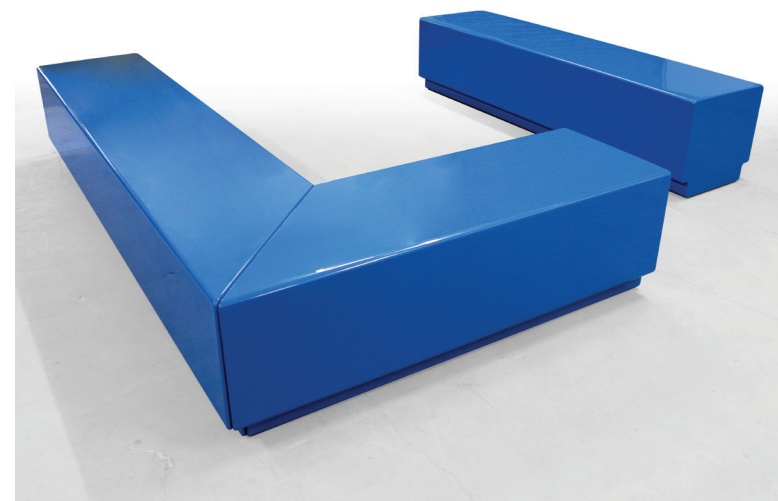
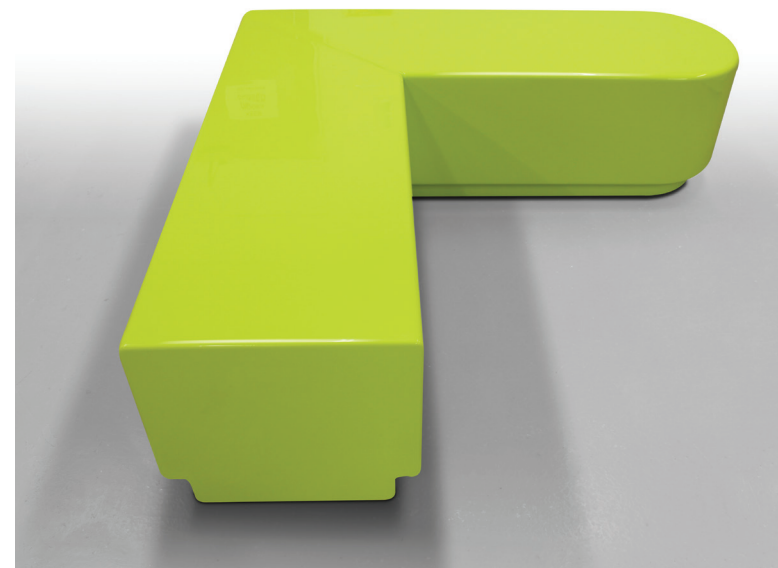

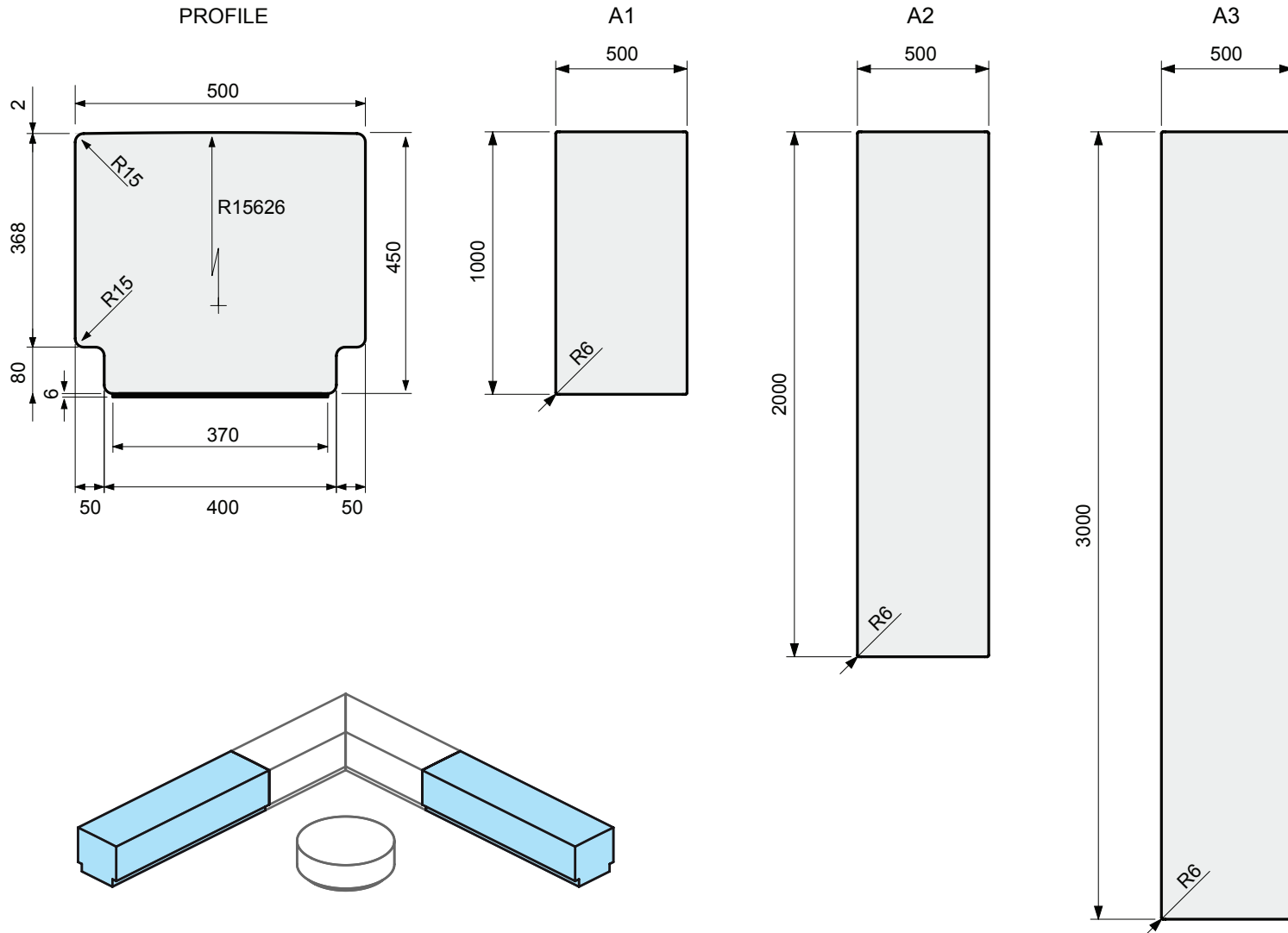

#### A1 - 1 metre seat segment

**Principal Material:** Composite moulded.

##### Dimensions:

1000 long x 500 x 456mm high.

##### Each segment can be supplied:

1. Weighted with a rubber anti-slide base. Approx. 45 kgs.
2. Un-weighted with rubber anti-slide base. Approx. 16 kgs.
3. Fitted with anchor bolts for permanent fixing. Approx. 15 kgs.

#### A2 - 2 metre seat segment

**Principal Material:** Composite moulded.

##### Dimensions:

2000 long x 500 x 456mm high.

##### Each segment can be supplied:

1. Weighted with a rubber anti-slide base. Approx. 45 kgs.
2. Un-weighted with rubber anti-slide base. Approx. 30 kgs.
3. Fitted with anchor bolts for permanent fixing. Approx. 28 kgs.

#### A3 - 3 metre seat segment

**Principal Material:** Composite moulded

##### Dimensions:

3000 long x 500 x 456mm high.

##### Each segment can be supplied:

1. Not available.
2. Un-weighted with rubber anti-slide base. Approx. 46 kgs.
3. Fitted with anchor bolts for permanent fixing. Approx. 43 kgs.



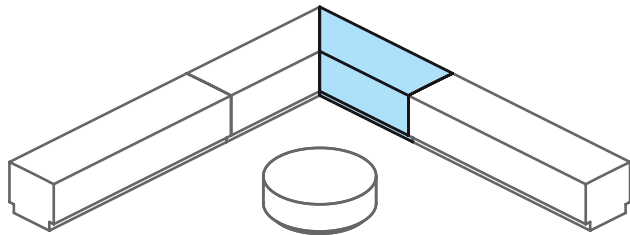
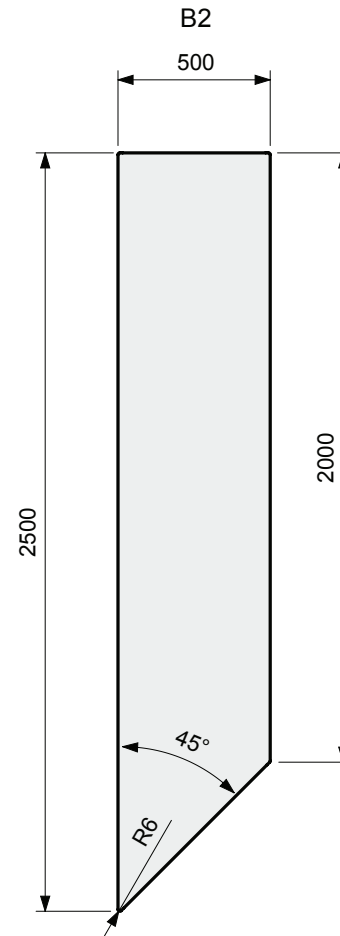
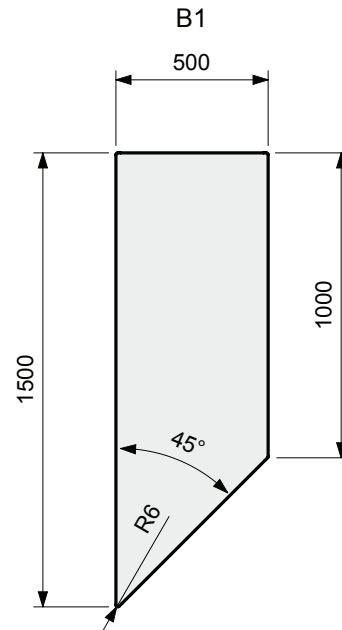
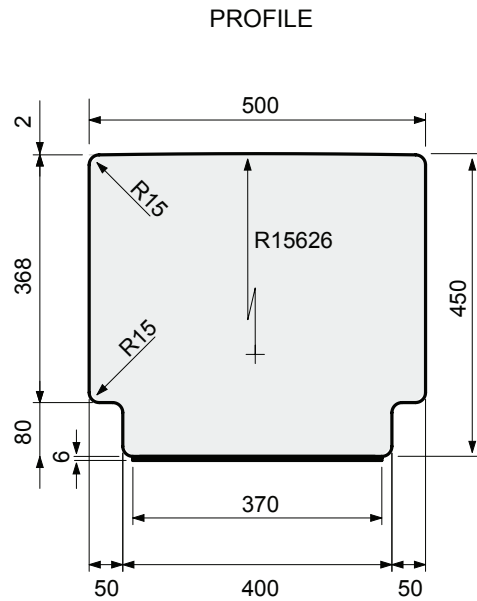

### B1 - 1.5 metre seat segment

**Principal Material:** Composite moulded.

#### Dimensions:

1500 long x 500 x 456mm high, with 45° end.

#### Each segment can be supplied:

1. Weighted with a rubber anti-slide base. Approx. 45 kgs.
2. Un-weighted with rubber anti-slide base. Approx. 18 kgs.
3. Fitted with anchor bolts for permanent fixing. Approx. 16 kgs.

### B2 - 2.5 metre seat segment

**Principal Material:** Composite moulded.

#### Dimensions:

2500 long x 500 x 456mm high, with 45° end.

#### Each segment can be supplied:

1. Weighted with a rubber anti-slide base. Approx. 45 kgs.
2. Un-weighted with rubber anti-slide base. Approx. 30 kgs.
3. Fitted with anchor bolts for permanent fixing. Approx. 28 kgs.



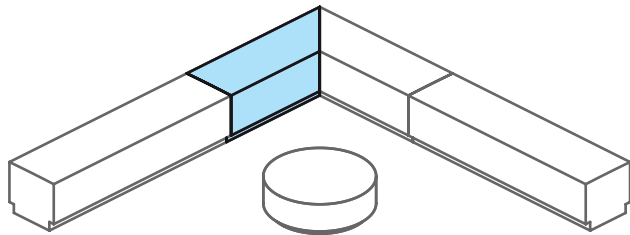
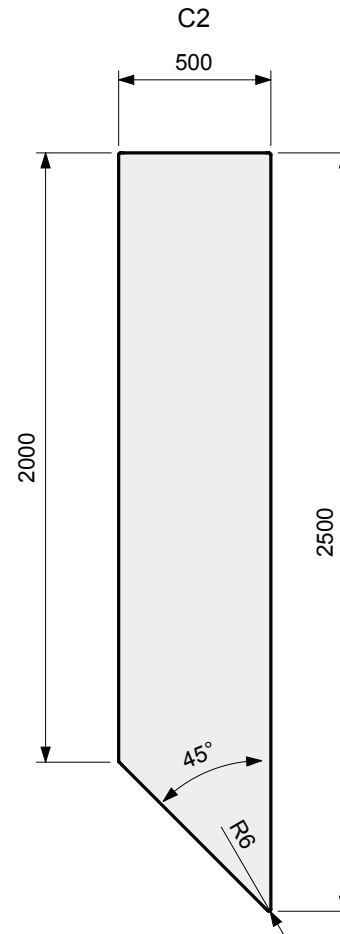
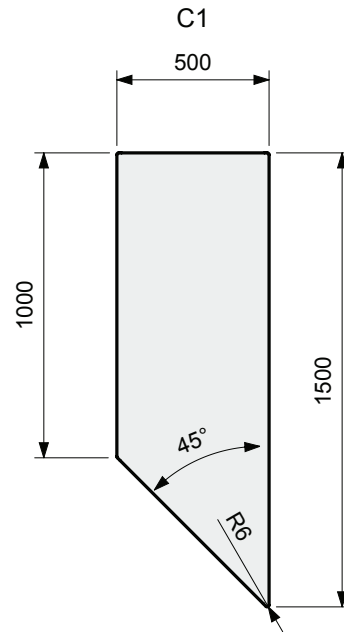
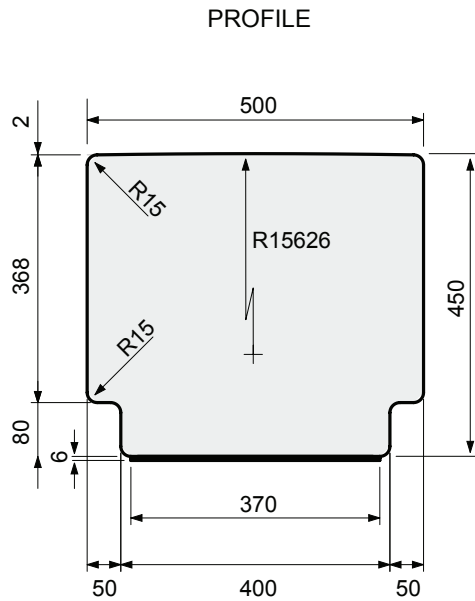

### C1 - 1.5 metre seat segment

**Principal Material:** Composite moulded.

#### Dimensions:

1500 long x 500 x 456mm high, with 45° end.

#### Each segment can be supplied:

1. Weighted with a rubber anti-slide base. Approx. 45 kgs.
2. Un-weighted with rubber anti-slide base. Approx. 18 kgs.
3. Fitted with anchor bolts for permanent fixing. Approx. 16 kgs.

### C2 - 2.5 metre seat segment

**Principal Material:** Composite moulded

#### Dimensions:

2500 long x 500 x 456mm high, with 45° end.

#### Each segment can be supplied:

1. Weighted with a rubber anti-slide base. Approx. 45 kgs.
2. Un-weighted with rubber anti-slide base. Approx. 30 kgs.
3. Fitted with anchor bolts for permanent fixing. Approx. 28 kgs.



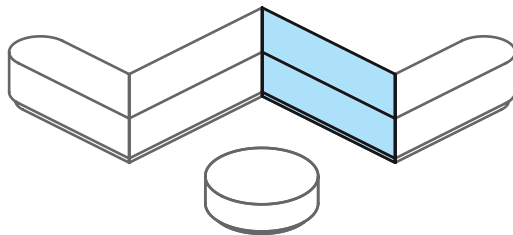
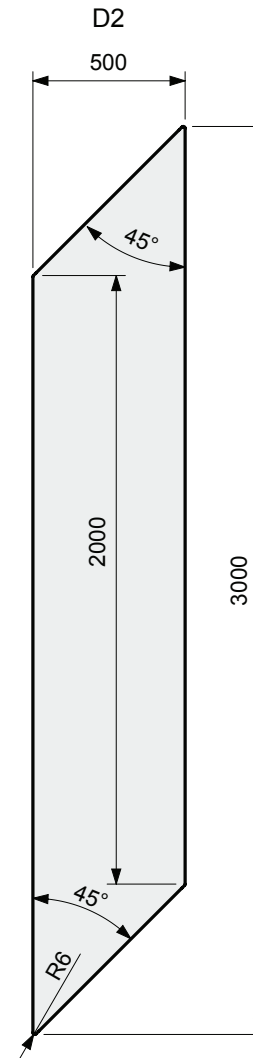
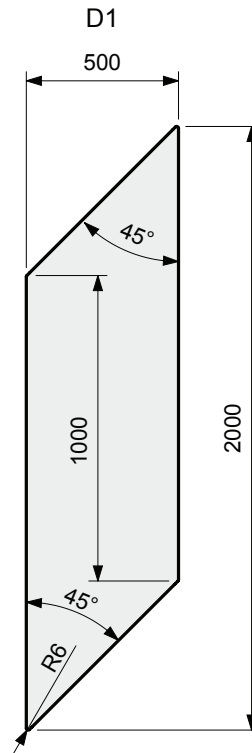
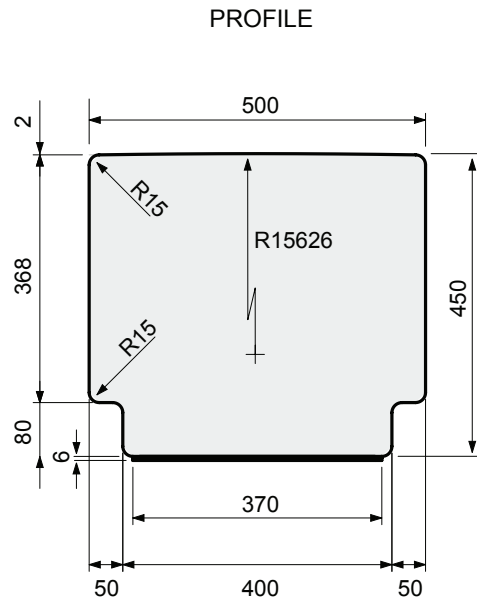

### D1 - 2 metre seat segment

**Principal Material:** Composite moulded.

#### Dimensions:

2000 long x 500 x 456mm high,  
with 45° ends.

#### Each segment can be supplied:

1. Weighted with a rubber anti-slide base. Approx. 45 kgs.
2. Un-weighted with rubber anti-slide base. Approx. 22 kgs.
3. Fitted with anchor bolts for permanent fixing. Approx. 20 kgs.

### D2 - 3 metre seat segment

**Principal Material:** Composite moulded.

#### Dimensions:

3000 long x 500 x 456mm high,  
with 45° ends.

#### Each segment can be supplied:

1. Weighted with a rubber anti-slide base. Approx. 45 kgs.
2. Un-weighted with rubber anti-slide base. Approx. 32 kgs.
3. Fitted with anchor bolts for permanent fixing. Approx. 30 kgs.



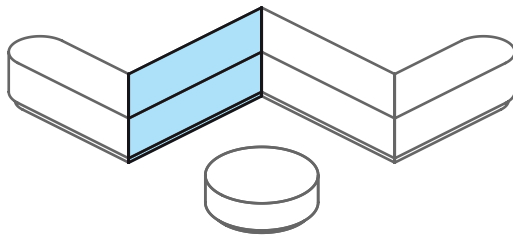
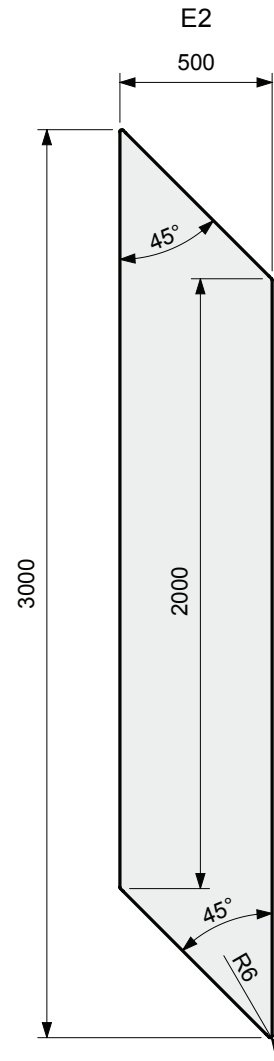
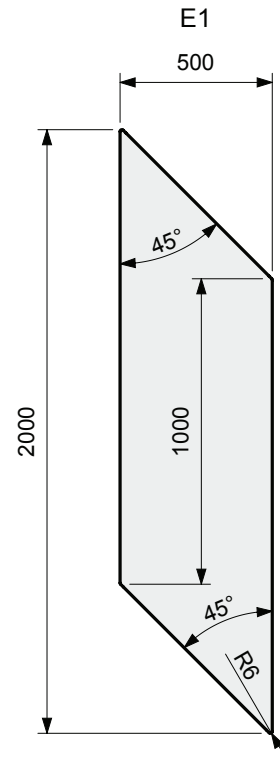
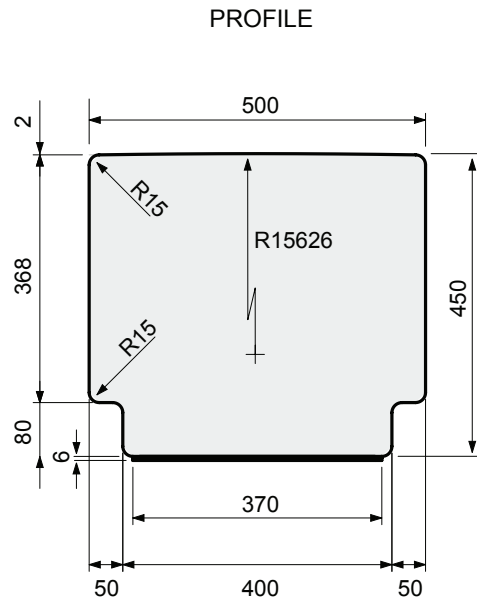

### E1 - 2 metre seat segment

**Principal Material:** Composite moulded.

#### Dimensions:

2000 long x 500 x 456mm high, with 45° ends.

#### Each segment can be supplied:

1. Weighted with a rubber anti-slide base. Approx. 45 kgs.
2. Un-weighted with rubber anti-slide base. Approx. 22 kgs.
3. Fitted with anchor bolts for permanent fixing. Approx. 20 kgs.

### E2 - 3 metre seat segment

**Principal Material:** Composite moulded.

#### Dimensions:

3000 long x 500 x 456mm high, with 45° ends.

#### Each segment can be supplied:

1. Weighted with a rubber anti-slide base. Approx. 45 kgs.
2. Un-weighted with rubber anti-slide base. Approx. 32 kgs.
3. Fitted with anchor bolts for permanent fixing. Approx. 30 kgs.

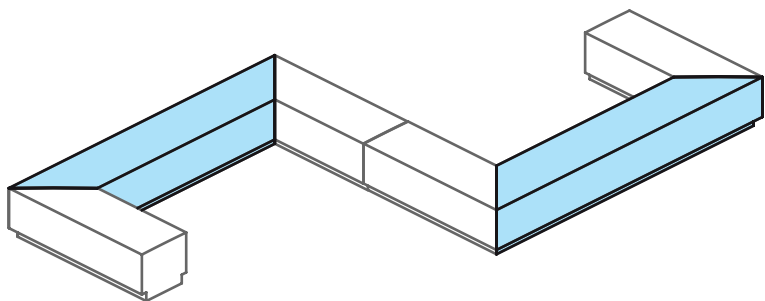
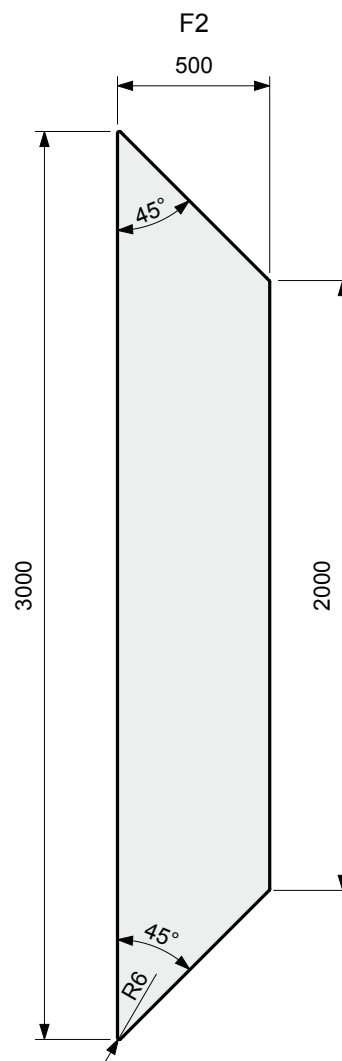
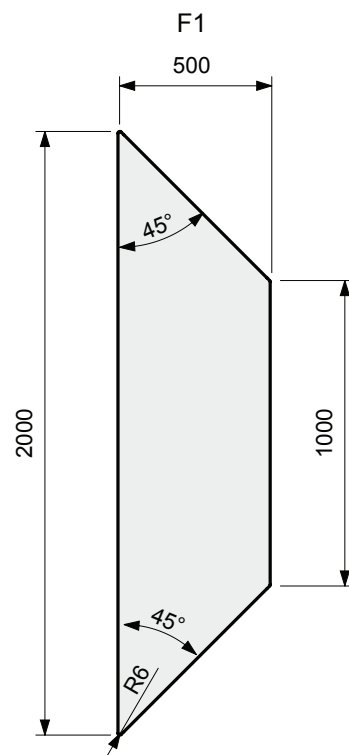
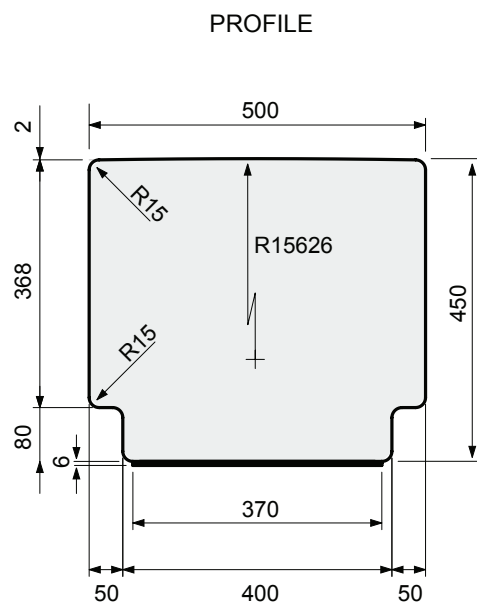

### F1 - 2 metre seat segment

**Principal Material:** Composite moulded.

#### Dimensions:

2000 long x 500 x 456mm high, with 45° ends.

#### Each segment can be supplied:

1. Weighted with a rubber anti-slide base. Approx. 45 kgs.
2. Un-weighted with rubber anti-slide base. Approx. 22 kgs.
3. Fitted with anchor bolts for permanent fixing. Approx. 20 kgs.

### F2 - 3 metre seat segment

**Principal Material:** Composite moulded.

#### Dimensions:

3000 long x 500 x 456mm high, with 45° ends.

#### Each segment can be supplied:

1. Weighted with a rubber anti-slide base. Approx. 45 kgs.
2. Un-weighted with rubber anti-slide base. Approx. 32 kgs.
3. Fitted with anchor bolts for permanent fixing. Approx. 30 kgs.



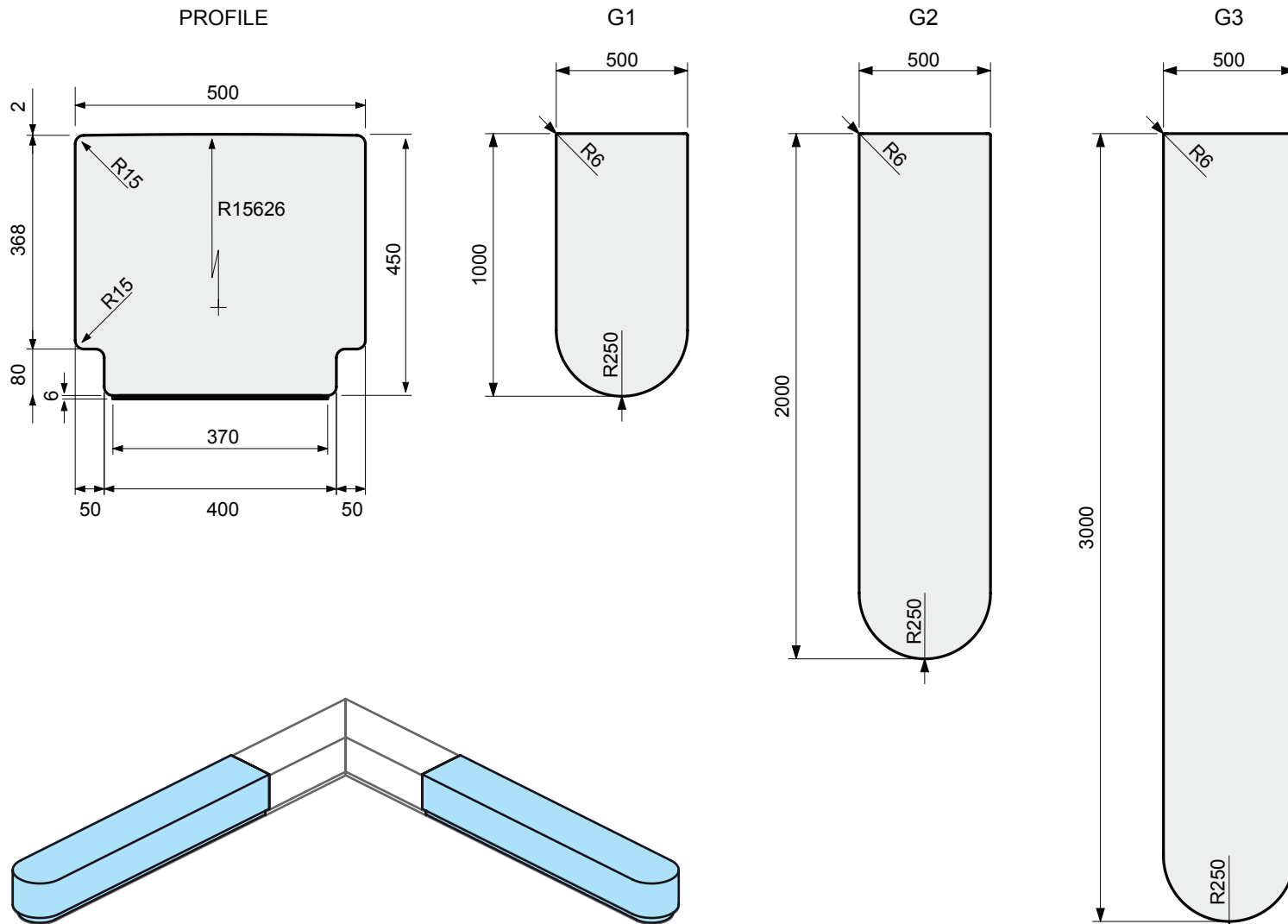

### G1 - 1 metre seat segment

**Principal Material:** Composite moulded

1000 long x 500 x 456mm high,  
with 250 radius end

**Each segment can be supplied:**

1. Weighted with a rubber anti-slide base. Approx. 45 kgs
2. Un-weighted with rubber anti-slide base. Approx. 16 kgs
3. Fitted with anchor bolts for permanent fixing. Approx. 15 kgs

### G2 - 2 metre seat segment

**Principal Material:** Composite moulded

2000 long x 500 x 456mm high,  
with 250 radius end

**Each segment can be supplied:**

1. Weighted with a rubber anti-slide base. Approx. 45 kgs
2. Un-weighted with rubber anti-slide base. Approx. 32 kgs
3. Fitted with anchor bolts for permanent fixing. Approx. 28 kgs

### G3 - 3 metre seat segment

**Principal Material:** Composite moulded

3000 long x 500 x 456mm high,  
with 250 radius end

**Each segment can be supplied:**

1. Not available.
2. Un-weighted with rubber anti-slide base. Approx. 46 kgs
3. Fitted with anchor bolts for permanent fixing. Approx. 43 kgs

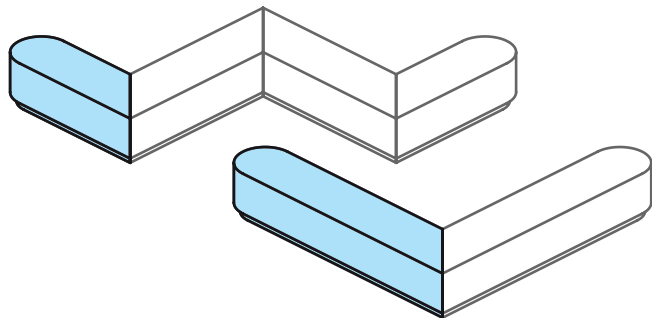
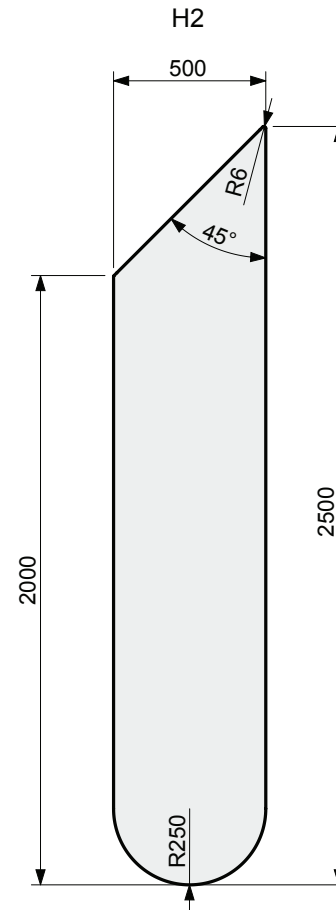
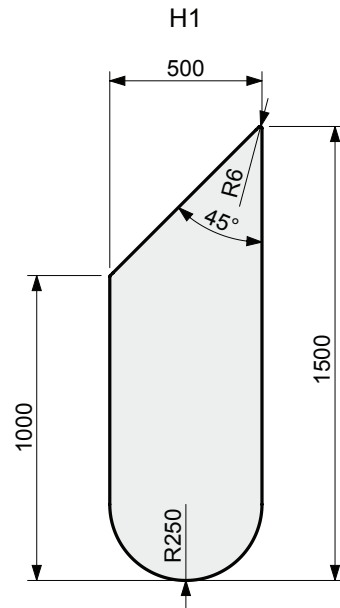
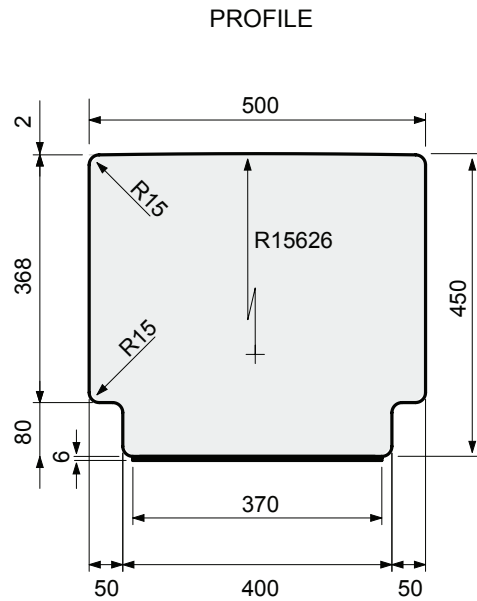

### H1 - 1.5 metre seat segment

**Principal Material:** Composite moulded.

**Dimensions:**

1500 long x 500 x 456mm high, with 45° & 250 radius end.

**Each segment can be supplied:**

1. Weighted with a rubber anti-slide base. Approx. 45 kgs.
2. Un-weighted with rubber anti-slide base. Approx. 18 kgs.
3. Fitted with anchor bolts for permanent fixing. Approx. 16 kgs.

### H2 - 2.5 metre seat segment

**Principal Material:** Composite moulded

**Dimensions:**

2500 long x 500 x 456mm high, with 45° & 250 radius end.

**Each segment can be supplied:**

1. Weighted with a rubber anti-slide base. Approx. 45 kgs.
2. Un-weighted with rubber anti-slide base. Approx. 30 kgs.
3. Fitted with anchor bolts for permanent fixing. Approx. 28 kgs.



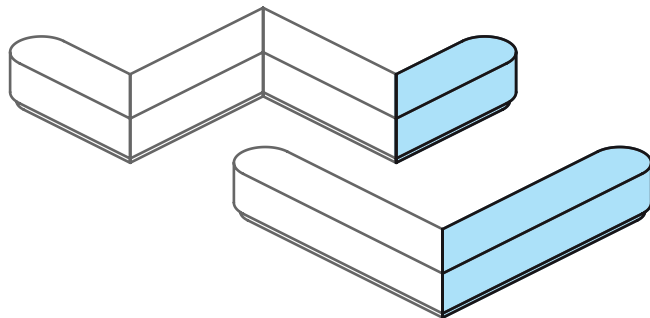
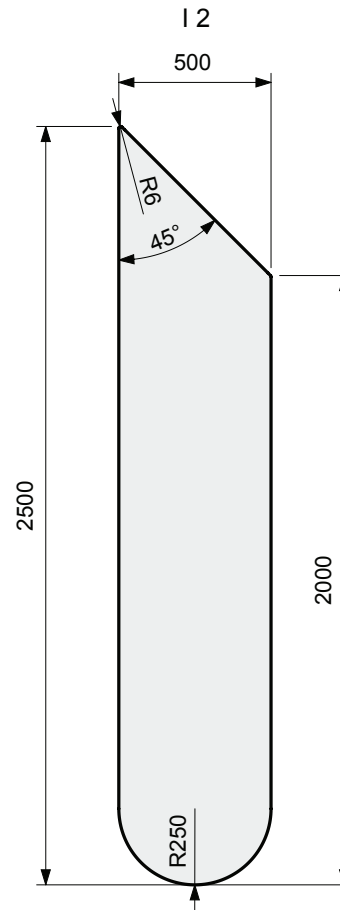
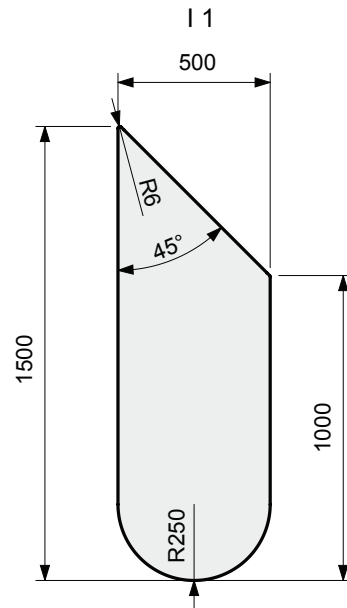
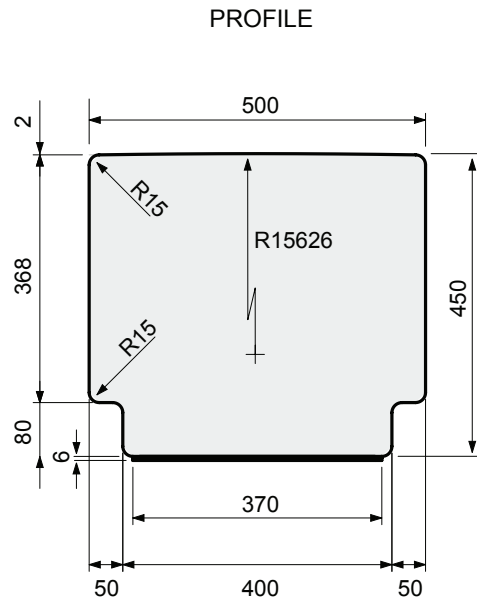

### I 1 - 1.5 metre seat segment

**Principal Material:** Composite moulded.

#### Dimensions:

1500 long x 500 x 456mm high, with 45° & 250 radius end.

#### Each segment can be supplied:

1. Weighted with a rubber anti-slide base. Approx. 45 kgs.
2. Un-weighted with rubber anti-slide base. Approx. 18 kgs.
3. Fitted with anchor bolts for permanent fixing. Approx. 16 kgs.

### I 2 - 2.5 metre seat segment

**Principal Material:** Composite moulded.

#### Dimensions:

2500 long x 500 x 456mm high, with 45° & 250 radius end.

#### Each segment can be supplied:

1. Weighted with a rubber anti-slide base. Approx. 45 kgs.
2. Un-weighted with rubber anti-slide base. Approx. 30 kgs.
3. Fitted with anchor bolts for permanent fixing. Approx. 28 kgs.

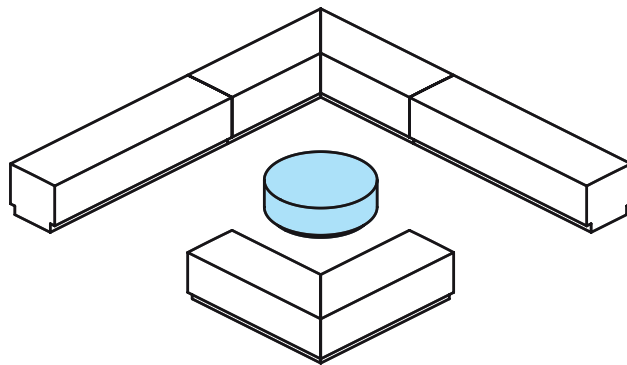

FRONT



PLAN

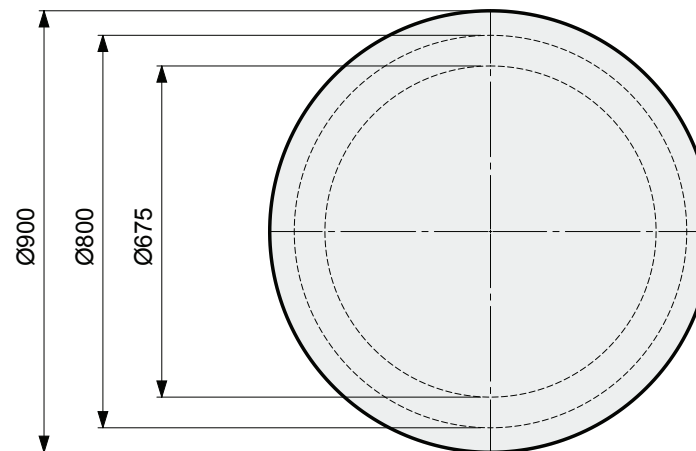

### J - 900 mm diameter coffee table

**Principal Material:** Composite moulded.

#### Dimensions:

900 diameter x 300mm high.

#### Each segment can be supplied:

1. Weighted with a rubber anti-slide base. Approx. 45 kgs.
2. Un-weighted with rubber anti-slide base. Approx. 22 kgs.
3. Fitted with anchor bolts for permanent fixing. Approx. 18 kgs.

#### Supply options:

1. **Weighted:** Modules supplied weighted to prevent people from easily moving installations to another area. Weighted modules are ideal if you would like the flexibility to move seating at a later date and the security that they will be safe.
2. **Un-weighted:** This supply option offers the utmost in flexibility and is ideal for domestic use or in areas where you want to move seats quickly and easily, such as events/exhibition spaces.
3. **Fitted with anchor bolts:** Modules are complete with anchor bolts for permanent fixing - ideal for public open spaces or where security may be an issue.



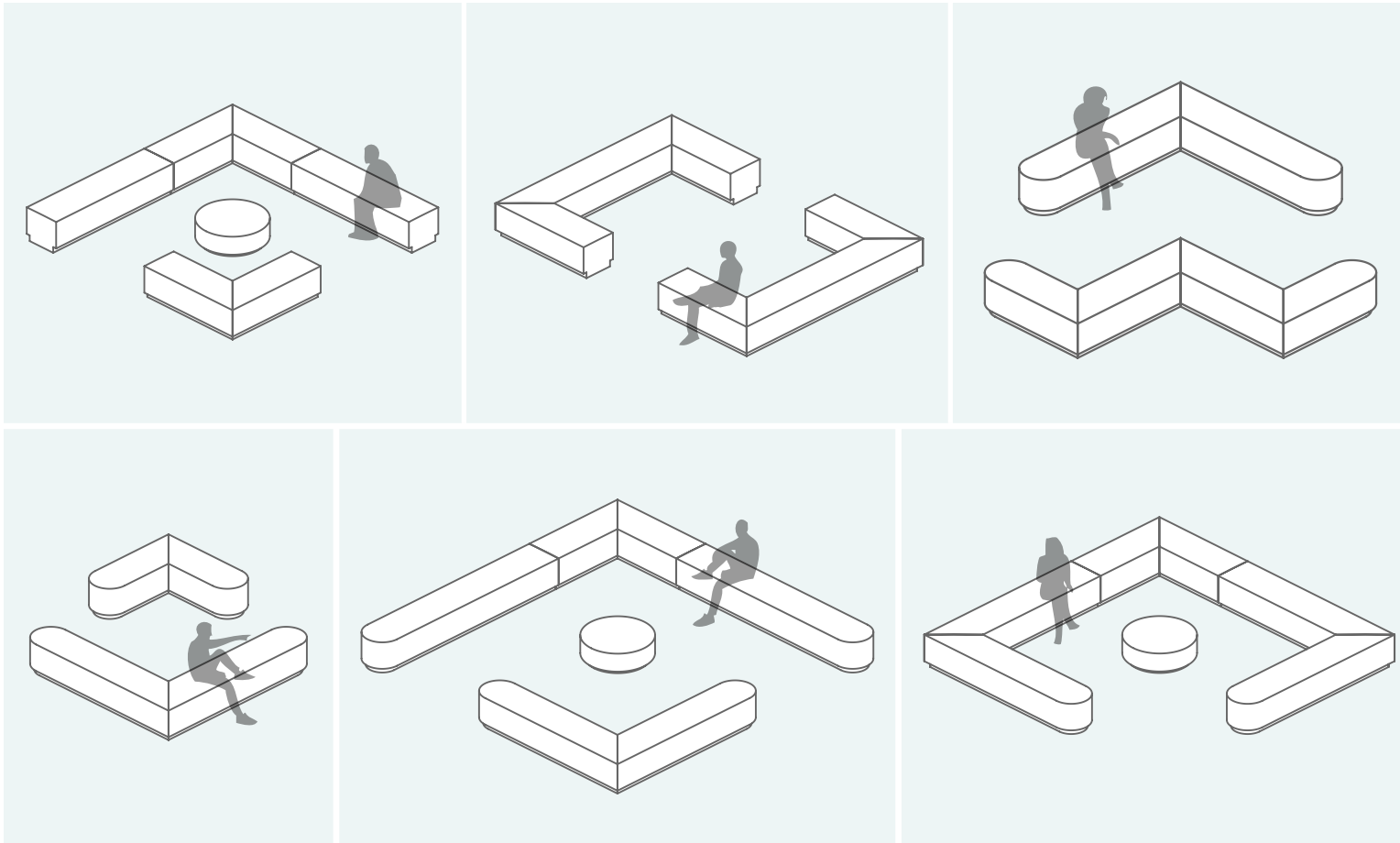

Just some of the many Bench modular arrangements.

Broxap Ltd

Rowhurst Industrial Estate  
Chesterton  
Newcastle-under-Lyme  
Staffordshire ST5 6BD

Tel: 01782 564411  
Fax: 01782 565357/562546

Email: [sales@broxap.com](mailto:sales@broxap.com)  
[www.broxap.com](http://www.broxap.com)