

Newcastle Duopitch Lattice BXMW/DUO-LATT



Standard Unit Dimensions:

Bespoke sizes to suit
customer requirements

Framework Colours/Finishes:

| | | |
|--|---|---|
|  Galvanised Only |  RAL 9006 White Aluminium |  RAL 7016 Anthracite Grey |
|  BS 4800 10 A 07 Nimbus Grey |  RAL 3020 Traffic Red |  RAL 9005 Jet Black |
|  BS 4800 14 C 39 Holly Green |  RAL 1023 Traffic Yellow |  BS 4800 00 A 05 Goose Grey |
|  RAL 5015 Mid Blue |  RAL 5013 Dark Blue |  RAL 9016 Traffic White |

The colours shown are a guide only.
Please check a colour chart to see the
actual colour.

Product Information

This Duopitch Lattice Canopy was initially built to provide coverage to a school courtyard for outdoor dining, but can be used in most applications. The Newcastle Duopitch Canopy has a range of uses, these include: Entrance canopies, Covered walkways, and Outdoor classrooms. This canopy also includes the following features; Offset apex roof, Clear multi-wall polycarbonate cladding and Submerged fixing.

Features

- Offset apex roof
- Clear multi-wall polycarbonate cladding
- Submerged fixing
- Welded end frames and purlin section made from heavy-duty box
- Hot dipped galvanised to BS EN ISO 1461:2009

Materials Used

- Framework - Mild steel
- Cladding - 16mm structured multi-wall polycarbonate
- Fasteners - Zinc plated
- Cover Strips - Aluminium capex

Finish Options (Framework)

- Galvanised to BS EN ISO 1461:2009
- Galvanised to BS EN ISO 1461:2009 & Polyester Powder Coated

Broxap Limited, Rowhurst Industrial Estate, Chesterton, Newcastle-under-Lyme, Staffordshire, ST5 6BD T: 01782 564411 E: info@broxap.com W: www.broxap.com



Newcastle Duopitch Lattice BXMW/DUO-LATT

Weather Resistance

Cladding is UV Stabilised
Wind resistant to 23m/s

Fire Resistance

Cladding is fire tested to '1Y' for BS 476

Guarantees, Warranties, Design-Life and Life-Expectancies

- 25 year structural guarantee*
- 34 year (min) life expectancy for Hot Dip Galvanizing
- 8-10 year life expectancy on standard powder coatings
- 10-15 year life expectancy on Duplex (Zinc Coated) powder coatings
- 10 years' manufacturers guarantees* on cladding material(s)
- 10 years' warranty* on material (only)
- 12 months' warranty* on parts & labour

**Maintenance and other qualifying criteria apply*

Options

- Internal lighting or solar lighting
- Opal, bronze or grey tinted multi-wall polycarbonate
- Full installation service

Standard Unit Dimensions:

Bespoke sizes to suit
customer requirements

Framework Colours/Finishes:

| | | |
|---|---|---|
|  |  |  |
| Galvanised Only | White Aluminium | Anthracite Grey |
|  |  |  |
| BS 4800 10 A 07 Nimbus Grey | Traffic Red | Jet Black |
|  |  |  |
| BS 4800 14 C 39 Holly Green | Traffic Yellow | Goose Grey |
|  |  |  |
| Mid Blue | Dark Blue | Traffic White |

The colours shown are a guide only.
Please check a colour chart to see the actual colour.

Diagram

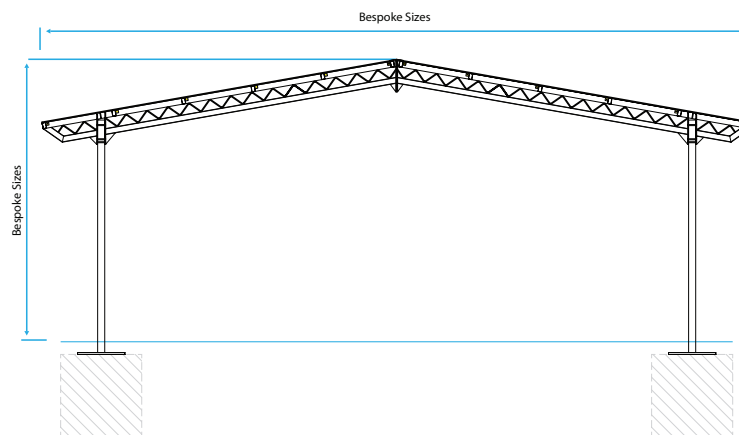

Installation

